

Notes:  
Design Standard DNV 2.7-1  
Tare: 2500Kgs  
S.W.L.: 12000Kgs  
Gross: 14500Kgs.

Gearbox Model #: KA87AM145  
Speed: 1400/8.0  
Gearbox Ratio : 174.91:1  
Lubricant: CLP220 Mineral Oil, 3.7 Ltrs  
MA Max (Nm) : 2.7  
Output Torque (Nm) : 2700.

Air motor model: Gast 16AM-FRV-13  
Max output: 5Kw  
Max output speed: 1500rpm

Max pull value: 565 Kgs (with drum weight of 6.9T)  
Max pull value thru Sheave: 285 Kgs  
Max Drum Speed: 10 rpm approx

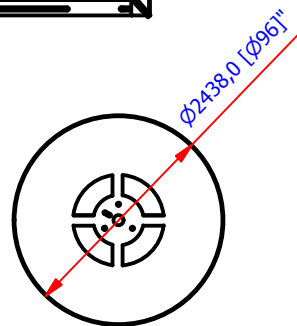
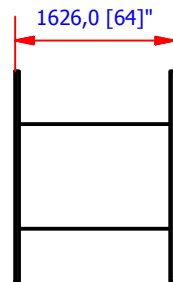
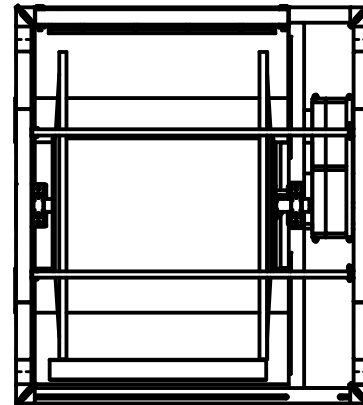
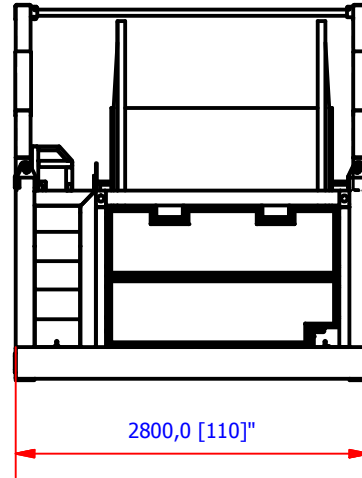
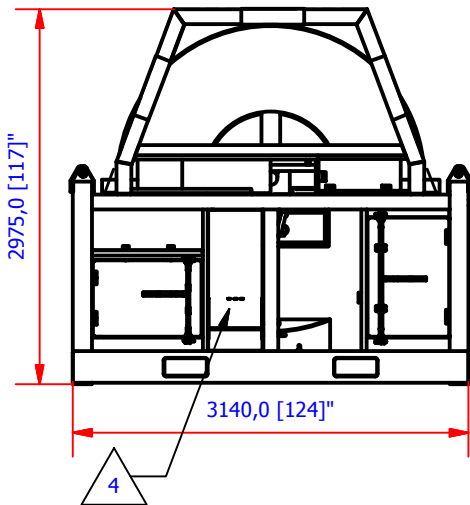

Spooler function tests.  
Tests completed with a drum weight of 6.9 Ton,  
Air required to rotate drum: 3 Bar  
Pulling force @ 3 bar = 116Kgs  
Pulling force @ 5 Bar = 287 Kgs  
Pulling force @ 7 Bar = 565 Kgs  
With 23Mtrs of ESP Cable laying on ground  
required 2.5-3 bar Bar to pull onto drum.

REVISION HISTORY

REV	BY	DESCRIPTION	DATE	CHKD	APPR	EXT AP	CL APP
4	DB	Changed Position of Pendant Control Connections, Updated Showcase to match	08.04.16	DB	IH	N/A	N/A

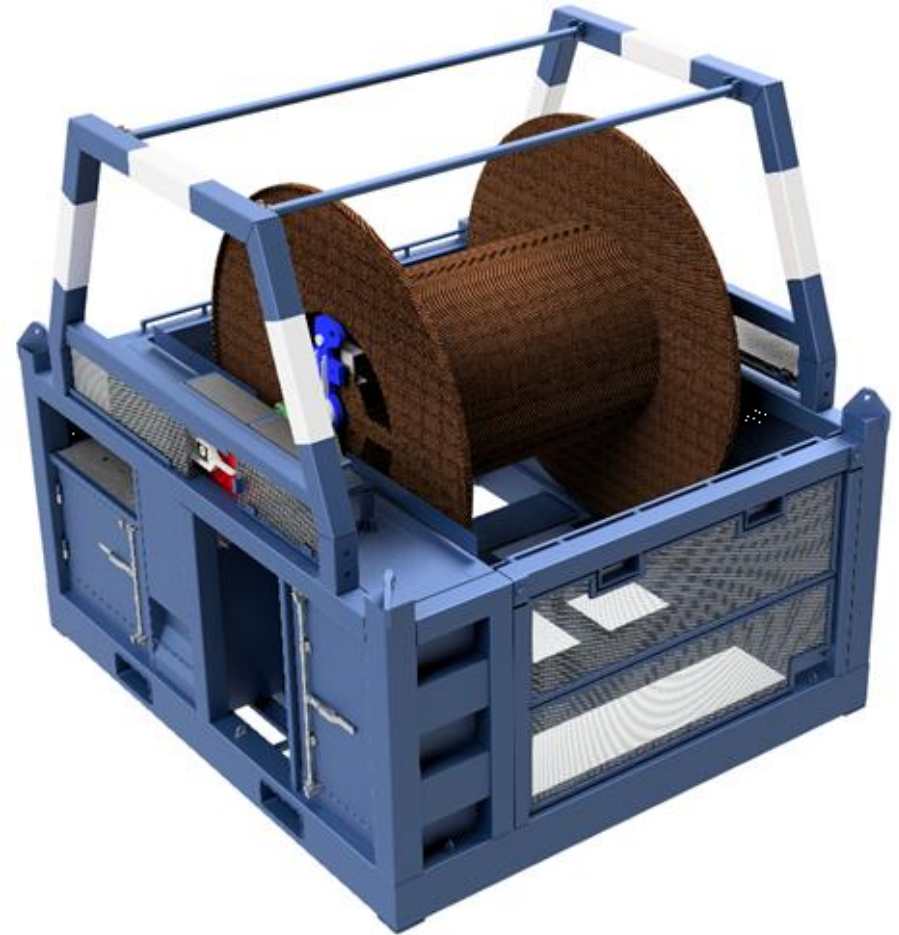

Max Drum Size: 96" Dia x 64" Wide, 4" Shaft

This drawing is copyright© and is the property of Blue Manta International, and must not be reproduced or used without the express permission of Blue Manta International.

General tolerances UNO  
Steel fabrications: ± 3.00mm  
Machining: ± 0.25mm  
Concentric: ± 0.05mm  
Angular: ± 0.05mm

Machined corner rads.  
Inside: ± 0.50mm UNO  
Outside: ± 0.65mm UNO

Description: **96" x 64" Spooler**

Part no: **02-9600**

Client: **Baker Hughes**

Drawing No: **BMD-625.SS**

Scale: **NTS @ A4**

